

200mm Wide concealed roof panel fastening bracket

Aluminium channel capping 60x30x2mm
Rivets through bent up flanges @ 400 crs.
Sealants=White polyurethane & mastic

Polystyrene to be painted with 'Flintcoat'

Galvanized steel hook bolts at all panel joint / purlin intersections

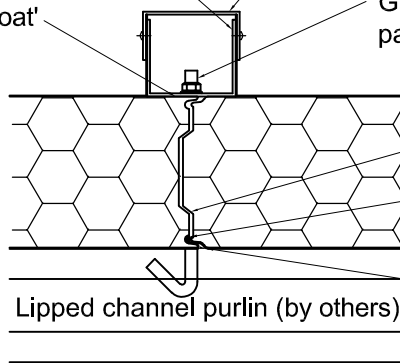

Standard panel inter-lock joint

Mastic inside panel joint (warm side)

Lipped channel purlin (by others)

Silicone sealant (Hygiene requirements only)